

Hedges Creek Culvert Crossing

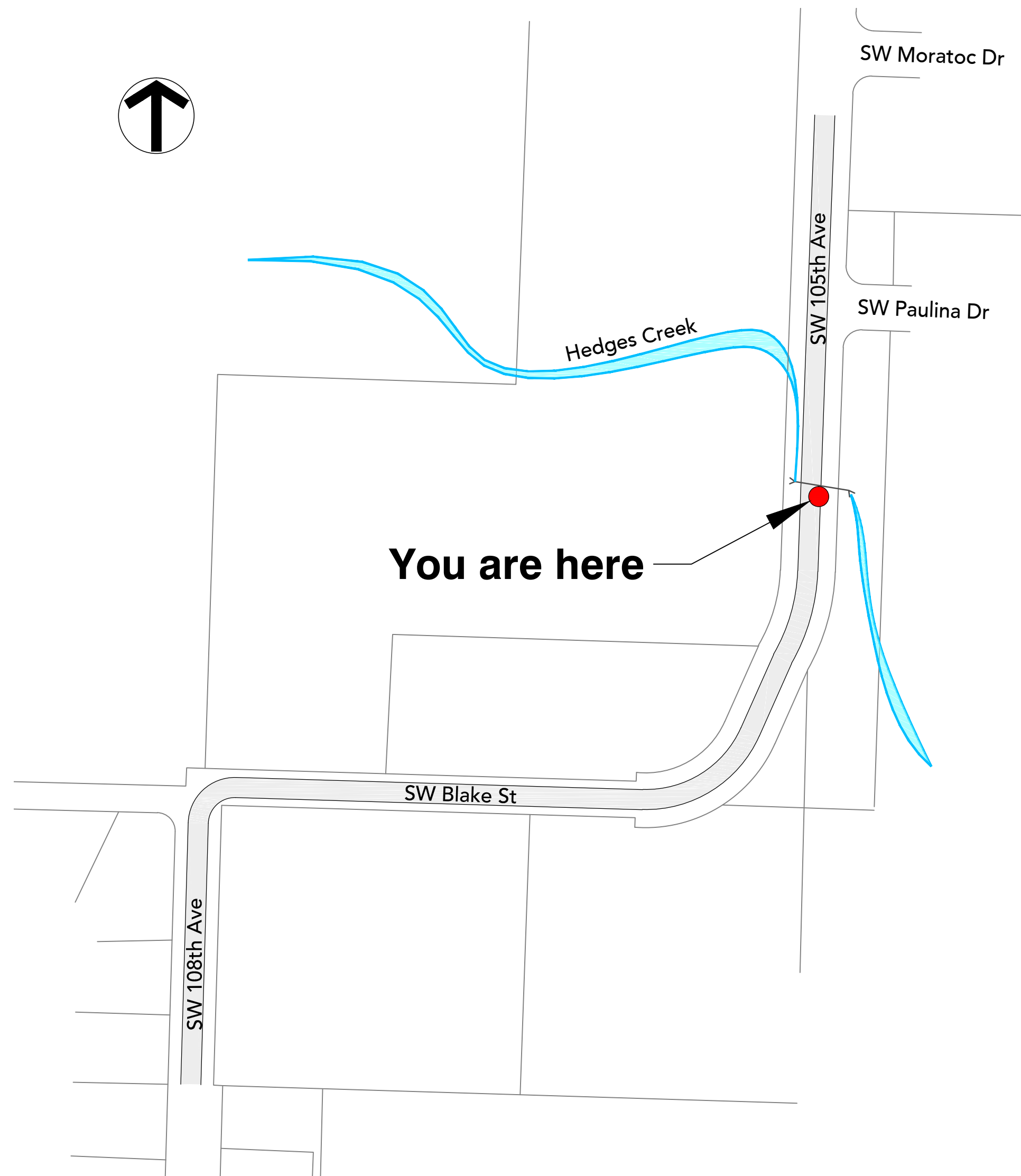

Existing Constraints

- Undersized culvert / flooding issues
- Fish and salmon habitat
- Nearby wetlands and riparian habitat
- Sanitary sewer line crosses road under culvert
- Adjacent steep slopes (> 25%)
- Dip in roadway limits visibility
- 60-ft wide public Right-of-Way
- Narrow roadway without shoulders
- No sidewalk, no bike lanes
- Limited roadway lighting

SW Blake & SW 108th Ave Intersection



Existing Constraints

- Significant crash history
- Tight curve with non-standard roadway geometry
- 10 mph advisory speed
- 40-ft wide public Right-of-Way
- Existing wall limits visibility
- Future Helenius Greenway Trail connection
- No sidewalk, no bike lanes
- Limited roadway lighting

SW Blake & SW 105th Ave Intersection

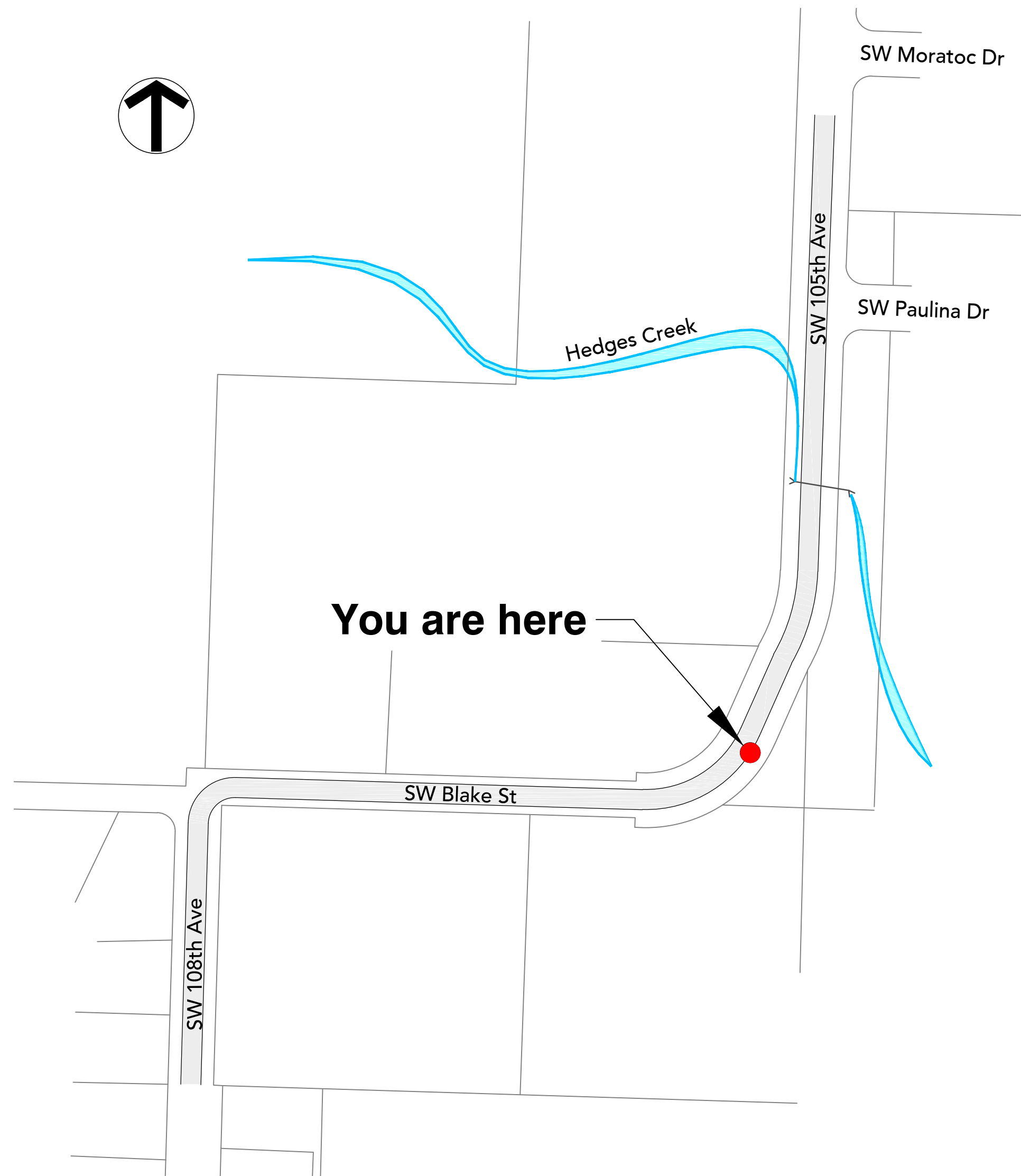

Existing Constraints

- Tight curve with non-standard roadway geometry
- 15 mph advisory speed
- Limited visibility on inside curve
- Guardrail protects vehicles from steep slopes
- Erosion along road edge
- 60-ft wide public Right-of-Way
- No sidewalk, no bike lanes
- Limited roadway lighting

Activated Warning Signal



What is this signal?

- Pedestrian and bicyclist activated warning signal
- Installed to address the use of the roadway by pedestrians and bicyclists
- Push the button, and the lights are activated for 10 minutes on the signs at SW 105th Ave and SW 108th Ave
- Installed at the end of sidewalks and bike lanes on SW 105th Ave and SW 108th Ave
- Includes a total of four poles with push buttons to activate the signal

Concerns

- Signage not well understood
- Lack of driver awareness
- Limited impact on vehicle speeds
- Lack of advance signs, long spacing between signs
- Not ADA compliant